

306 Reckturner / Horizontal Bar Gymnast

LEVEL

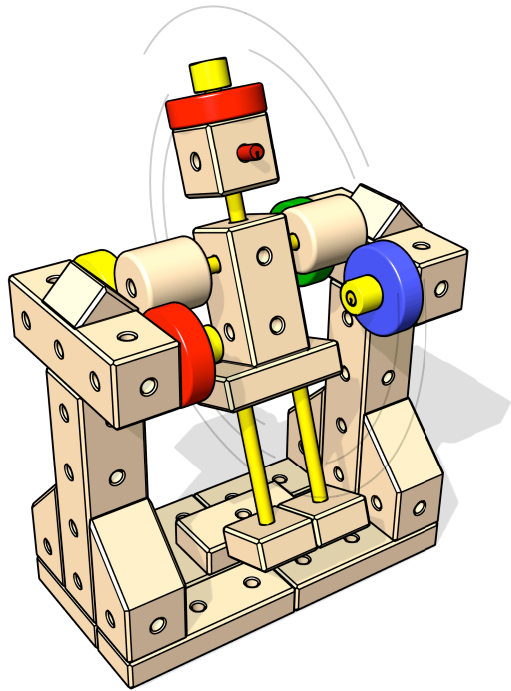

- 1x 1
- 1x 2
- 2x 3
- 2x 4

- 2x 1/2
- 4x

- 2x 1
- 2x 2
- 2x 3

- 2x 6
- 2x

- 2x
- 1x
- 5x

- 1x
- 1x
- 22x
- 8x
- 2x

A x2

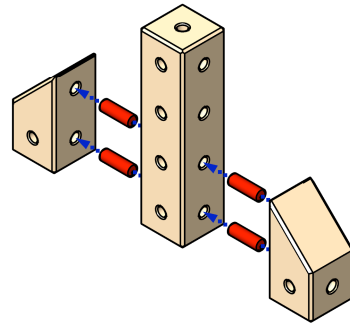

1

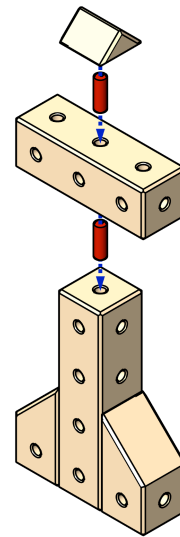

2

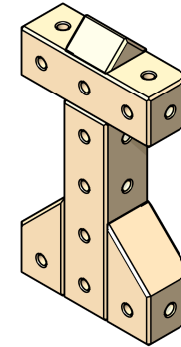

3

B

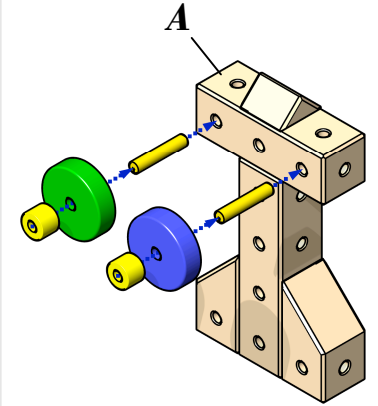

A 4

C

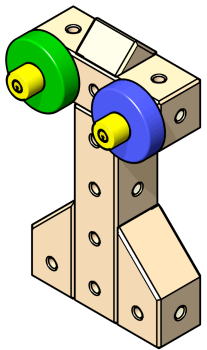

5

B 6

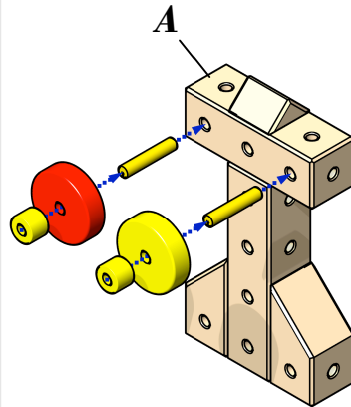

6

D

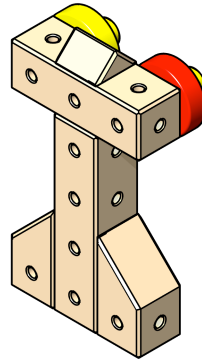

7

D

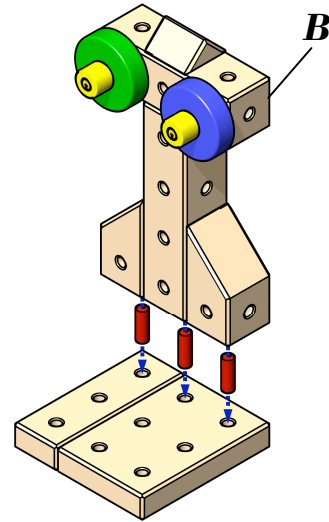

C 8

9

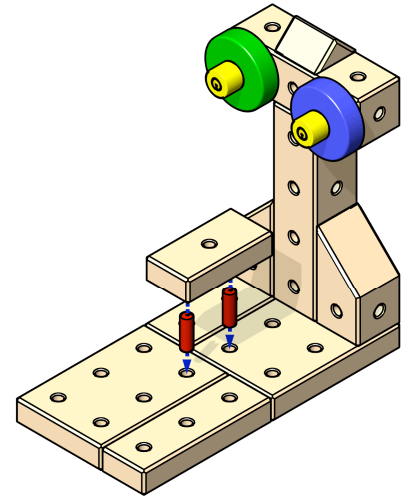

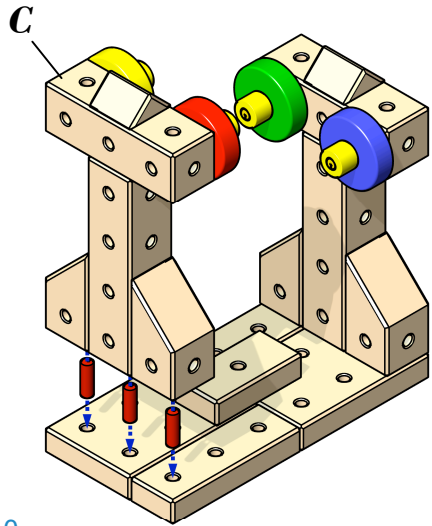

10

D 11

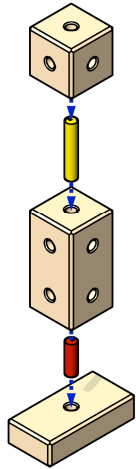

12

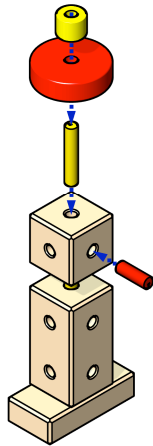

13

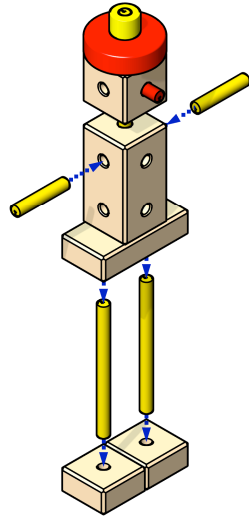

14

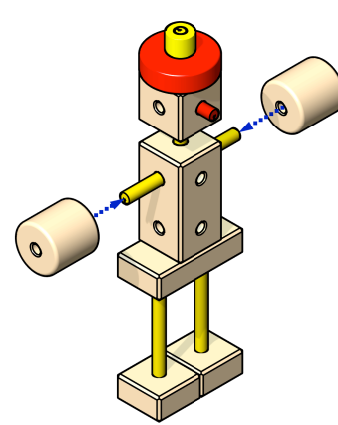

15

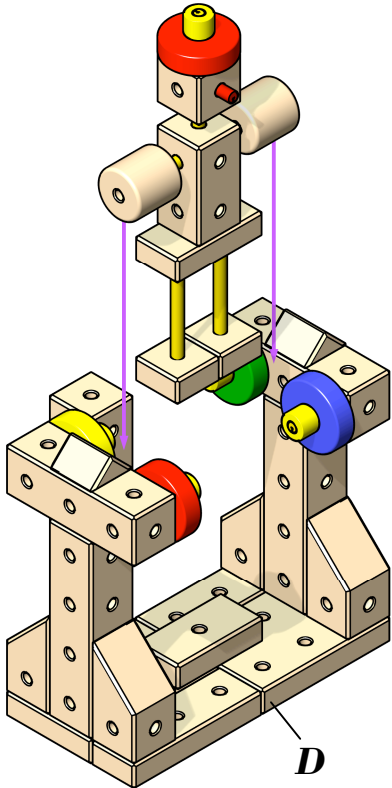
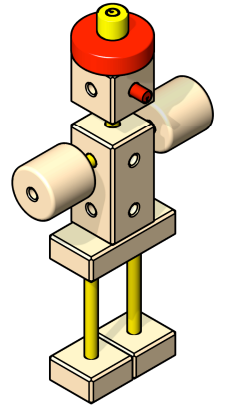

16

