







303 Schildkröte / Turtle

LEVEL

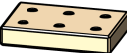
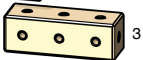
- 1x  1
- 1x  1/2
- 2x  6
- 1x  3
- 4x  1/2
- 9x  1
- 2x  1

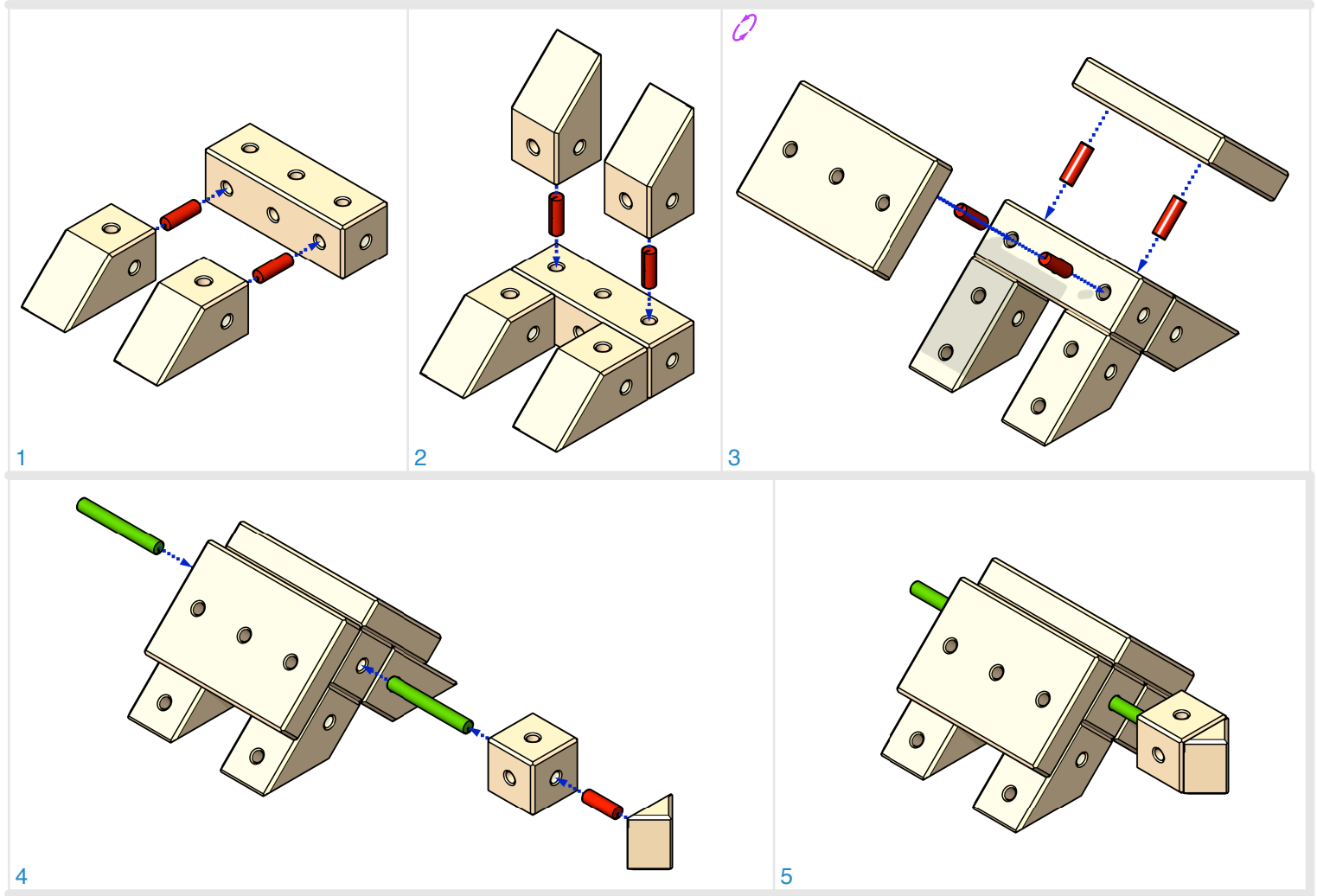
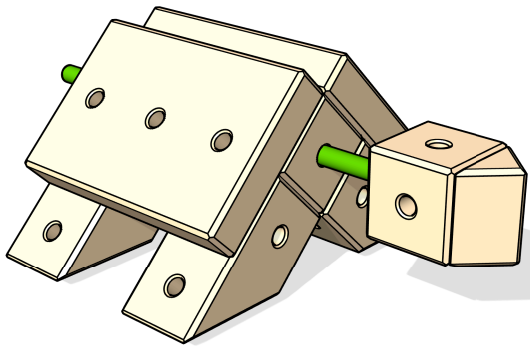

The assembly diagram is divided into five numbered steps:

- Step 1:** A 1-hole square brick is placed on top of a 3-hole long brick. Two 1-hole triangular wedges are attached to the bottom of the 3-hole brick with red pins.
- Step 2:** Two more 1-hole triangular wedges are attached to the bottom of the 3-hole brick with red pins. Two 1-hole square bricks are placed on top of the 3-hole brick, one on each side of the central hole.
- Step 3:** A 6-hole long brick is placed on top of the 3-hole brick. Two red pins are inserted through the 6-hole brick into the 1-hole square bricks. A 1-hole square brick is placed on top of the 6-hole brick, and two red pins are inserted through it into the 6-hole brick.
- Step 4:** A green axle is inserted through the 1-hole square brick on top of the 6-hole brick, through the 1-hole square brick on the side of the 3-hole brick, and through the 1-hole square brick at the end of the 3-hole brick. A 1-hole triangular wedge is attached to the end of the 3-hole brick with a red pin.
- Step 5:** The final assembly is shown, which is the completed turtle shell.